



# **JIASHAN FUSHENG SLIDING BEARING CO., LTD.**

嘉善富盛滑动轴承有限公司

# 公司简介

## Company Introduction

JIASHAN FUSHENG

嘉善富盛滑动轴承有限公司

Sliding Bearing

JIASHAN FUSHENG

嘉善富盛滑动轴承有限公司

Sliding Bearing

嘉善富盛滑动轴承有限公司是生产各类滑动轴承的专业性实体企业。在多年生产实践中，始终坚持管理和技术的创新，十分注重学习和借鉴国内外同行经验，并与国内大专院校，科研机构建立密切联系，坚持以科技为先导，以质量求发展，建立了严格的质量保证体系，企业的技术水平和产品质量不断提高。企业以“不断进步，力争一流”为经营宗旨，努力为客户提供一流的产品和服务。

产品广泛应用于：汽车、冶金、矿山、造船、纺织、印刷、建筑、注塑等各个机械制造领域，产品不但销售国内20多个省市，而且远销美国、德国、日本、意大利、韩国、东南亚等地区。

公司一贯坚持以一流的产品，良好的售后服务，与客户携手并进，共创美好的明天。

A Brief Introduction of FUSHENG Self-Lubricating bearing Co.,ltd. As an expert manufacture of all sorts of axletree, for years we been focusing in the innovations of management and technology, as well as learning form the successful competitors both from domestic and overseas. The good co-operation with local universities and academies ensures the tech-oriented, quality-based development of our company, we have developed high standard of quality assurance system. We are working hard to provide our customers with products and services of superb quality, as in our nission statement:keep on upgrading and be the top one.

The products of which are widely used in automobiles, metallurgy, mine, ships, spin and weave, printing, architecture, log-on and so on. In addition, Not only our products are sold to more than 20 provinces and cities, but also far to USA, German, Japan, Italy, Korea, Southeast Asia and other countries & regions.

We will offer the best service and the products which be top-ranking to every client. The beautiful tomorrow belongs to you and us.

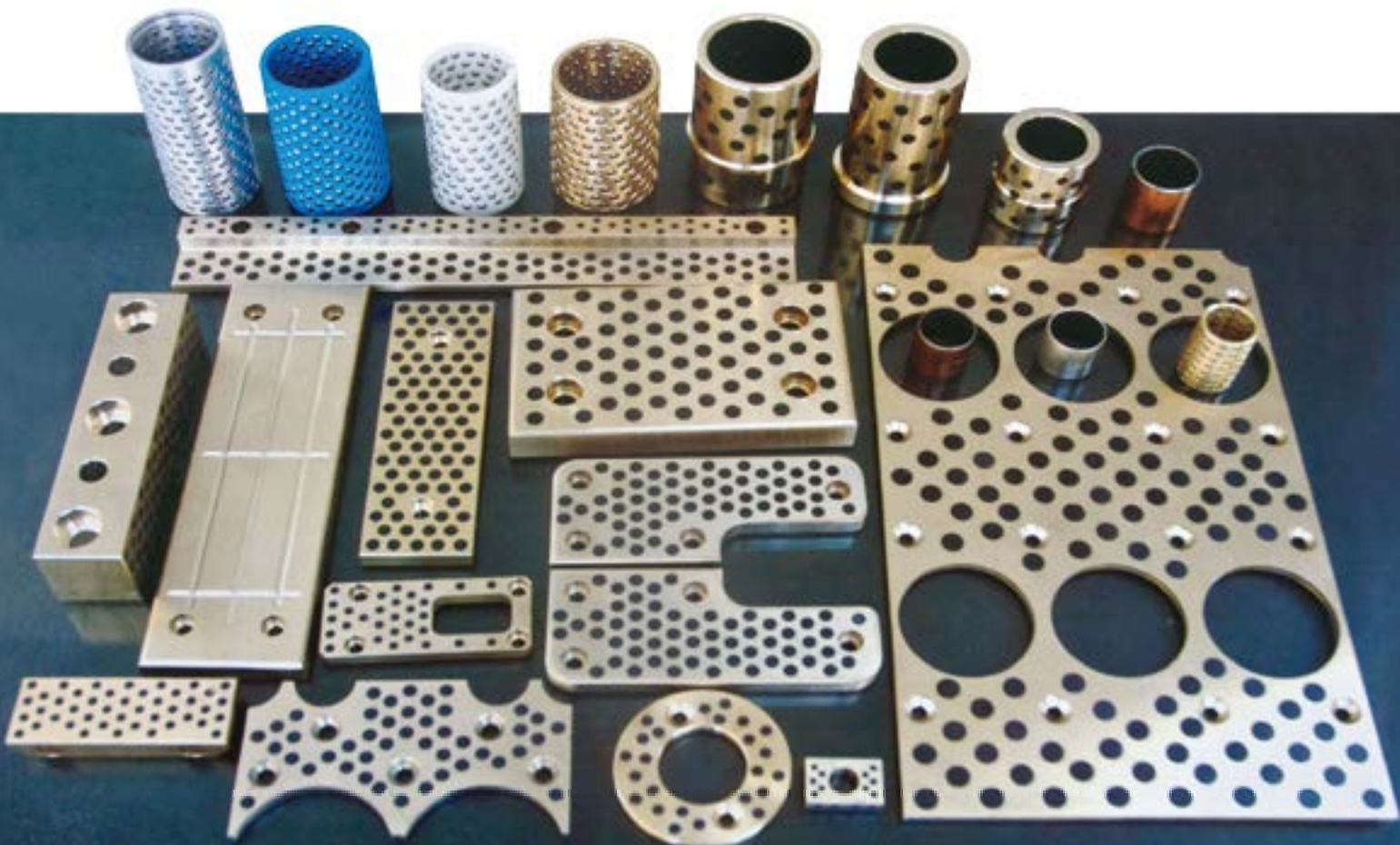

JDB650	JFB650	JFBB650	JTW650	JNA
				
GB250	HGB250	JDBS	JGBF	JGBU
				
FZH	FZL	FZP	FZPL	JDB600
				
JTWP	JSP	JGBX	JSP	JOPW
				
JSP650	JSP650	JSPB	JSPB	JSL
				
JSPB	JSPB	JSPB	JSPB	JSPB
				
JSPB	JSPB	JSPB	JSPB	JSPB
				
JSPB	JSPB	JSPB	JSPB	JSPB
				
JSPB	JSPB	JSPB	JSPB	JSPB
JSPB	JSPB	JSPB	JSPB	JSPB
JSPB	JSPB	JSPB	JSPB	JSPB
JSPB	JSPB	JSPB	JSPB	JSPB
JSPB	JSPB	JSPB	JSPB	JSPB
JSPB	JSPB	JSPB	JSPB	JSPB
JSPB	JSPB	JSPB	JSPB	JSPB
JSPB	JSPB	JSPB	JSPB	JSPB
JSPB	JSPB	JSPB	JSPB	JSPB
JSPB	JSPB	JSPB	JSPB	JSPB
JSPB	JSPB	JSPB	JSPB	JSPB
JSPB	JSPB	JSPB	JSPB	JSPB
JSPB	JSPB	JSPB	JSPB	JSPB
JSPB	JSPB	JSPB	JSPB	JSPB
JSPB	JSPB	JSPB	JSPB	JSPB
JSPB	JSPB	JSPB	JSPB	JSPB
JSPB	JSPB	JSPB	JSPB	JSPB
JSPB	JSPB	JSPB	JSPB	JSPB
JSPB	JSPB	JSPB	JSPB	JSPB
JSPB	JSPB	JSPB	JSPB	JSPB
JSPB	JSPB	JSPB	JSPB	JSPB
JSPB	JSPB	JSPB	JSPB	JSPB
JSPB	JSPB	JSPB	JSPB	JSPB
JSPB	JSPB	JSPB	JSPB	JSPB
JSPB	JSPB	JSPB	JSPB	JSPB
JSPB	JSPB	JSPB	JSPB	JSPB
JSPB	JSPB	JSPB	JSPB	JSPB
JSPB	JSPB	JSPB	JSPB	JSPB
JSPB	JSPB	JSPB	JSPB	JSPB
JSPB	JSPB	JSPB	JSPB	JSPB
JSPB	JSPB	JSPB	JSPB	JSPB
JSPB	JSPB	JSPB	JSPB	JSPB
JSPB	JSPB	JSPB	JSPB	JSPB
JSPB	JSPB	JSPB	JSPB	JSPB
JSPB	JSPB	JSPB	JSPB	JSPB
JSPB	JSPB	JSPB	JSPB	JSPB
JSPB	JSPB	JSPB	JSPB	JSPB
JSPB	JSPB	JSPB	JSPB	JSPB
JSPB	JSPB	JSPB	JSPB	JSPB
JSPB	JSPB	JSPB	JSPB	JSPB
JSPB	JSPB	JSPB	JSPB	JSPB
JSPB	JSPB	JSPB	JSPB	JSPB
JSPB	JSPB	JSPB	JSPB	JSPB
JSPB	JSPB	JSPB	JSPB	JSPB
JSPB	JSPB	JSPB	JSPB	JSPB
JSPB	JSPB	JSPB	JSPB	JSPB

## ➔ 产品简述 Product Brief

固体润滑轴承是在轴承基体的金属摩擦面上开出排列有序大小适当的孔穴，并嵌入具有独特自润滑性能的成型固体润滑剂制成的自润滑轴承。该轴承综合了金属基体和具有特殊配方的润滑材料和各种优点。突破了一般轴承依靠油膜润滑的界限性。固体润滑轴承特别适用于无油、高温、高负荷、低速度，防污、防蚀、防辐射，以及在水中或真空溶液浸润而根本无法加润滑油的特殊工况条件下使用。

产品广泛应用于冶金轧钢设备、矿山机械、船舶机械、船舶工业、航天航海、水轮机、气轮机、灌装设备、仪器仪表、纺织机械，并在其它工业机械中有着广阔的应用领域，并得到了越来越多的使用。

Solid-lubricant-inlaid bushing is the self-lubricant bushing which is based on the metal friction surface of the bushing basement where holes are spreaded reasonably in proper size and specific solid lubricant which has self-lubricant function is inserted, This kind of bushing has included the advantages of the metal basement and lubricant materials that has the specific direction for producing chemicals. It has broken in the limit of general bushings that depend on oil film. Solid-lubricant-inlaid bushing is especially applied in oil-free high temperature, High load, low speed, contamination resistance, corrosion resistance radiation resistance as well as the use under such special work conditions as in the water or being soaked by vacuum solution so that cannot add lubricant oil film.

The products is widely applied in metallurgy and steel-rolling equipment, mine machinery, shipping machinery, shipping industry. Space voyage, hydraulic turbine, gas turbine, filling equipment, instruments and weave machinery. It also has a wide rang of application in other industrial and agriculture machinery. And it is being used more and more widely.

## ➔ JDB 应用特点 Application

JDB 是通用的基础产品，无论高压、低压、高温、低温、有油润滑、无油润滑还是水中润滑都能适应。产品的基体是高力黄铜，比一般的铜套硬度提高一倍，耐磨性能提高一倍以上，因此在冶金行业的连铸机、轧机、输送机上都可采用。还用于塑料注塑机锁模机构，挤出机构，高压电的自动开关，建筑机械的起吊支撑部位，以及水利枢纽工程的弧门支撑，滑轮和传动轮部位。还有造纸机烘道、汽车模具、船舶起锚滑动部位等。

JDB Can be used under low, middle and high load. When under high load, wear performance desgrades accordingly. It's a general-purpose product and be applied under low or high pressure, low or high temperature, and oil, water or dry lubrication. The base material is high strength brass and its hardness doubles than normal bronze so that wear performance improves in large degree. Can be applied in consistent cast machine, rolling machine, conveyor equipment; plastic injection machine, high voltage switch; hoisting supporter, hydraulic gate supporter, paper-making machine, automobile die etc.

## ➔ 主要材料推荐 Main Materials Recommendation

### 合金材质 Metal Type

FSB 标准 FSB Standard	高力黄铜 Cast bronze	铜合金 Copper alloy	铜合金 Copper alloy	铜合金 Copper alloy	特硬高力黄铜 Strong cast bronze	铸铁 Cast iron
Base material 基本材质	CuZn24Al6	CuSnZn5Pb5	CuAl10Ni5	CuSn12	CuZn24Al6	HT250
Hardness HB 硬度	>210	>70	>150	>80	>250	>160
Tensile strength 抗拉强度 N/mm <sup>2</sup>	>750	>200	>500	>360	>800	>250
Elongation% 伸长率	>12	>15	>10	>8	>4	
Coefficient of linear expansion 热胀系数	1.9*10 <sup>-5</sup> /°C	1.8*10 <sup>-5</sup> /°C	1.6*10 <sup>-5</sup> /°C	1.8*10 <sup>-5</sup> /°C	1.9*10 <sup>-5</sup> /°C	1.0*10 <sup>-5</sup> /°C
Limit Temp. 温度	300°C	400°C	400°C	400°C	300°C	400°C
Max. Load N/mm <sup>2</sup> 最大动承载	100	60	50	70	150	10
Max. Speed m/min 最大线速度	15	10	20	10	10	15
Max. Pv 最大 PV N/mm <sup>2</sup> *m/min	200	200	200	200	200	200
压缩永久变形量 400N/mm <sup>2</sup>	<0.01	<0.05	<0.04	<0.05	<0.05	<0.015

同时FSB可以根据客户的特别要求提供HB>270及HB>300的特高硬铜材料

As special request FSB also can supply the strong cast bronze of special high hardness HB>270, HB>300

## ➔ 固体润滑剂 Solid Lubricants

固体润滑剂 Lubricants	特性 Features	典型用途 Typical application
高纯石墨 + 添加剂 Si1 Graphite+add	很好的耐磨性和化学稳定性，使用温度 <400°C Excellent resistance against chemical attacks and low friction. Temp. limit 400°C	适用于一般机械，在大气中使用 Suite for general machines and under atmosphere
SL4+MOS2 PTFE+MOS2+CF	极低的摩擦系数和很好的水润滑性，使用温度 <300°C Lowest in friction and good of water lubrication, Temp. limit 300°C	适用于水、海水润滑，如船舶、水工弧门，水轮机、制药饮料机械等 Ship, hydraulic turbine, gas turbine etc.

## ➔ 产品简述 Product Brief

FZH (铜基)、FZL (铝基)、FZP (树脂基) 钢球保持圈, 分别以铜合金、硬铝合金、POM树脂为基体, 并在其外圆表面上, 加工出排列有序、大小适当, 形状特殊的孔穴, 在其孔穴中镶入滚动轴承钢球。采用最新的沟槽圆周锁球工艺, 有效地解决了传统式锁球和压痕式锁球不能完全防止钢球脱落的难题。孔底加工出90°止口使钢球在孔内自由转动而不脱落。由于钢球的直径大于保持圈的壁厚, 所以在使用时钢球高出保持圈内、外圆表面, 直接与相配的孔与轴接触, 使基体(保持圈)浮于中间, 并且相配的孔与轴半径之差小于钢球直径, 即钢球与之配合为过盈配合, 配合精度高, 轴与孔相对运动灵活。是保持圈的更新换代产品。

FZH. FZL. FZP. ball retainer are as copper, aluminium, POM base. they are machined some regular holes and embedded the steel-ball into. The new work-craft will prevent the ball getting out of as old. as the ball diameter is larger than the retainer s thickness, so it will face to face directly with 90° guide bushing, that will bring high precision match now the ball retainer series items are designed to rotate on the post, as well as maintainits vertical motion. we believe this will give you the benefit of increasing accijracy.

## ➔ 优点与用途 Advantage and Application Scope

传统的具有相对运动的孔与轴是有一定间隙的, 并孔与轴之间运动摩擦系数较大, 使用钢球保持圈后, 使轴与孔不直接接触, 而是通过中间微量过盈的钢球, 因而运动精度高, 滚动摩擦代替滑动摩擦, 滚动灵活, 摩擦系数小, 使用寿命长, 在既有转动、又有移动的场所, 用无油或加油的轴套与轴相配合, 虽然能满足, 但运动精度较低, 用滚动轴承, 只能满足轴相对转动的场合, 而钢球保持圈, 则上述二个条件均得到满足, 目前已广泛应用于冷冲模滚动模架、高精度机床、机床附件以及要求高精度轴向或轴径向同时运动场合。

As the traditional work-craft has some grudge between bushing with posts, and the coefficient of friction is larger. now we have changed the work-ways to steel-ball directly face to face guide bushing, so the precision is improved. it composes of both active roll and lower friction coefficient, now they have been widely used in punching machine, die machine, high precision machine which need rotation and vertical motion.

## ➔ 相配零件的要求 Installed Spares Requested

- 1.导套: 材料GCr15、YB9, 热处理, 硬度HRC62~66, 技术条件按GB/T12446与轴配合应具有0.01-0.02径向过盈量, 表面粗糙度为  $0.05/\sqrt{\text{R}}$
- 2.轴: 材料GCr15、YB9, 热处理, 硬度HRC62~66, 技术条件按GB/T12446, 轴的公差采用h5, 表面粗糙度为  $0.09/\sqrt{\text{R}}$
- 3.测量: 用通用的测量手段 (气动量仪、外径千分尺、内径千分表等) 测量轴导套和钢球的尺寸偏差值, 即可求出配合后的过盈量, 即  $Y_{\max} = d_{\max} + 2d - D_{\min}$ , 要求过盈量为 0.01-0.02mm.

1. Guide bushing: material GCr15, YB9, heat treatment HRC62-66, technique condition according to GB/T1 2446. Request 0.01-0.02mm the surface roughness is  $0.05/\sqrt{\text{R}}$
2. Guidie posts: matrial GCr15, YB9, heat treatment HRC62-66, the tolerance of shaft is h5, the surface roughness is  $0.05/\sqrt{\text{R}}$
3. Size test: it is tested by outside micrometer & dial gauge as usual. The  $Y_{\max}$  ( $Y_{\max} + 2d' - D_{\min}$ ) request 0.01-0.02mm.

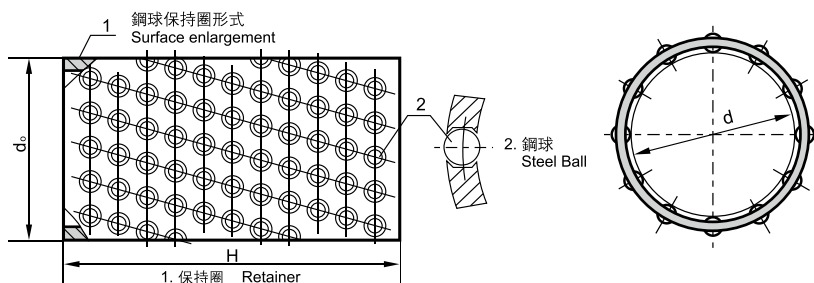
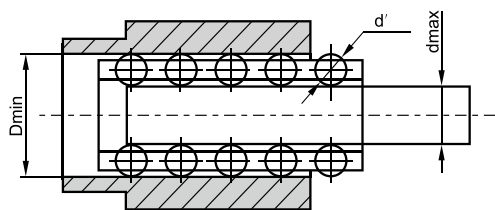
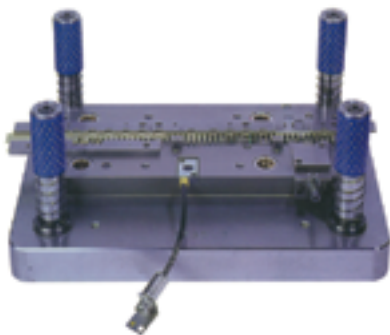

# 钢球保持架参数 (标准型) (B型)

STEEL BALL RETAINER PARAMETERS (STANDARD MODEL) (B)



## JIASHAN FUSHENG Sliding Bearing

嘉善富盛滑动轴承有限公司



Unit(单位): mm

规格	每圈孔数	每排孔数	钢球数	钢球直径	规格	每圈孔数	每排孔数	钢球数	钢球直径	规格	每圈孔数	每排孔数	钢球数	钢球直径	
16*30	10	5	50	3mm & 1/8"	28*50	14	7	98	4mm & 5/32"	38*80	16	9	144	5mm & 3/16"	
16*45	10	8	80		28*60	14	9	126		38*90	16	11	176		
18*40	12	7	84		28*75	14	11	154		40*80	18	9	162		
18*50	12	8	96		28*80	14	12	168		40*90	18	11	198		
18*60	12	10	120		30*50	16	7	112		45*60	18	7	126		
19*50	12	8	96		30*60	16	9	144		45*80	18	9	162		
19*60	12	10	120		30*75	16	11	176		45*85	18	10	180		
20*40	12	7	84		30*80	16	12	192		45*90	18	11	198		
20*45	12	8	96		32*50	16	7	112		50*90	20	11	220		
20*50	12	8	96		32*60	16	9	144		50*100	20	12	240		
20*60	12	10	120		32*75	16	11	176		50*110	20	13	260		
22*40	14	7	98		32*80	16	12	192		55*90	22	11	242		
22*50	14	8	112		32*90	16	13	208		55*100	22	12	264		
22*60	14	10	140		32*100	16	15	240		55*110	22	13	28		
22*70	14	12	168		35*60	18	9	162		60*100	24	12	288		
25*40	16	7	112		35*75	18	11	198		60*110	24	13	314		
25*50	16	8	128		35*80	18	12	216		65*100	26	12	312		
25*60	16	10	160		35*90	18	13	234		65*110	26	13	338		
25*70	16	12	192		35*100	18	15	270		70*90	28	11	308		
25*75	16	13	208		38*70	18	10	180		70*100	28	12	336		
28*40	18	7	126		38*80	18	12	216		80*130	30	16	480		
28*50	18	8	144		38*85	18	12	216		80*150	30	18	540		
28*60	18	10	180		40*70	20	10	200							
28*70	18	12	216		40*80	16	9	144							
28*75	18	13	234		40*90	16	11	176							
28*80	18	14	252		40*100	16	12	192							

# 钢球保持架参数 (密珠型) (A型)

STEEL BALL RETAINER PARAMETERS (DENSE MODEL) (A)



## JIASHAN FUSHENG Sliding Bearing

嘉善富盛滑动轴承有限公司



Unit(单位): mm

规格	每圈孔数	每排孔数	钢球数	钢球直径	规格	每圈孔数	每排孔数	钢球数	钢球直径	规格	每圈孔数	每排孔数	钢球数	钢球直径
10*21	6	7	42	2mm & 2.5mm	22*60	10	18	180	3mm & 1/8"	38*60	13	14	182	4mm & 5/32"
10*30	6	11	66		22*70	10	22	220		38*70	13	16	208	
10*40	6	15	90		25*48	12	14	168		38*80	13	18	234	
12*30	7	11	77		25*60	12	18	216		40*95	13	18	286	
12*40	7	15	105		25*70	12	22	264		45*90	14	21	294	
12*120	7	47	329		25*75	12	23	276		35*160	10	30	300	
13*25	7	9	63		25*240	12	77	924		35*210	10	40	400	
13*30	7	11	77		28*60	13	18	234		38*70	11	13	143	
13*40	7	15	105		28*70	13	22	286		38*90	11	17	187	
14*25	8	9	72		28*75	13	23	299		40*90	12	17	204	
14*30	8	11	88		28*50	10	11	110	45*85	13	15	195		
14*40	8	15	120		28*60	10	14	140	45*90	13	17	221		
15*30	8	11	88		28*75	10	17	170	50*80	14	15	210		
15*40	8	15	120		28*80	10	18	180	50*90	14	17	238		
16*25	9	9	81		30*50	11	11	121	50*100	14	19	266		
16*35	9	11	99		30*60	11	14	154	50*110	14	21	294		
16*40	9	15	135		30*75	11	17	187	55*90	15	17	255		
16*45	9	17	153		30*80	11	18	198	55*100	15	19	285		
16*30	8	8	64		31*55	11	12	132	55*110	15	21	315		
16*40	8	12	96		31*85	11	20	220	60*90	16	17	272		
16*45	8	14	112	32*60	12	14	168	60*100	16	19	304			
16*60	8	18	144	32*75	12	17	204	60*110	16	21	336			
18*40	9	12	108	32*80	12	18	216	65*90	17	17	289			
18*50	9	15	135	32*85	12	20	240	65*100	17	19	323			
18*60	9	18	162	32*90	12	21	252	65*110	17	21	357			
20*40	9	12	108	32*100	12	23	276	70*90	18	17	306			
20*45	9	14	126	35*60	12	14	168	70*110	18	21	378			
20*50	9	15	135	36*75	12	17	204	80*130	20	24	480			
20*60	9	18	162	35*80	12	18	216	80*150	20	28	560			
22*40	10	12	120	35*90	12	21	252							
22*50	10	15	150	35*100	12	23	276							

# 钢球保持架参数（特密型）（C型）

STEEL BALL RETAINER PARAMETERS (HIGH DENSE MODEL) (C)



## JIASHAN FUSHENG Sliding Bearing

嘉善富盛滑动轴承有限公司



Unit(单位): mm

规格	每圈孔数	每排孔数	钢球数	钢球直径	规格	每圈孔数	每排孔数	钢球数	钢球直径	规格	每圈孔数	每排孔数	钢球数	钢球直径
10*21	9	7	63	2mm & 2.5mm	22*60	12	18	216	3mm & 1/8"	35*90	16	21	336	4mm & 5/32"
10*30	9	11	99		22*70	12	22	264		35*100	16	23	368	
10*40	9	15	135		25*48	14	14	196		38*60	17	14	238	
12*30	10	11	110		25*60	14	18	252		38*70	17	16	272	
12*40	10	15	150		25*70	14	22	308		38*80	17	18	306	
12*120	10	47	470		25*75	14	23	322		40*95	17	22	374	
13*25	10	9	90		25*240	14	77	1078		45*90	18	21	378	
13*30	10	11	110		28*60	15	18	270		35*80	13	15	195	
13*40	10	15	150		28*70	15	22	330		35*90	13	17	221	
14*25	11	9	99		28*75	15	23	345		38*70	14	13	182	
14*30	11	11	121		30*70	16	22	352		38*90	14	17	238	
14*40	11	15	165		30*80	16	25	400		40*90	15	17	255	
15*30	11	11	121		28*50	14	11	154		45*80	16	15	240	
15*40	11	15	165		28*60	14	14	196		45*90	16	17	272	
16*25	11	9	99		28*75	14	17	238		50*80	17	15	255	
16*35	11	11	121		28*80	14	18	252		50*90	17	17	289	
16*40	11	15	165		30*50	15	11	165		50*100	17	19	323	
16*45	11	17	187		30*60	15	14	210		50*110	17	21	357	
16*30	10	8	80	30*75	15	17	255	55*90	18	17	306			
16*40	10	12	120	30*80	15	18	270	55*100	18	19	342			
16*45	10	14	140	31*55	15	12	180	55*110	18	21	378			
16*60	10	18	180	31*85	15	20	300	60*90	19	17	323			
18*40	11	12	132	32*60	15	14	210	60*100	19	19	361			
18*50	11	15	165	32*75	15	17	255	60*110	19	21	399			
18*60	11	18	198	32*80	15	18	270	65*90	20	17	340			
20*40	12	12	144	32*85	15	20	300	65*100	20	19	380			
20*45	12	14	168	32*90	15	21	315	65*110	20	21	420			
20*50	12	15	180	32*100	15	23	345	70*90	21	17	357			
20*60	12	18	216	35*60	16	14	224	70*110	21	21	441			
22*40	12	12	144	36*75	16	17	272	80*130	23	24	552			
22*50	12	15	180	35*80	16	18	288	80*150	23	28	644			



- ◎ 成型机械注塑机、橡胶机械、压铸机
- ◎ Injection Machine, Rubber Machine, Die-Casting Machines



# JDB 标准轴承套尺寸

NORMAL SIZE FOR JDB BEARING



材质	高力黄铜 + 石墨
Material	CuZn25Al5Mn3Fe3+Graphite

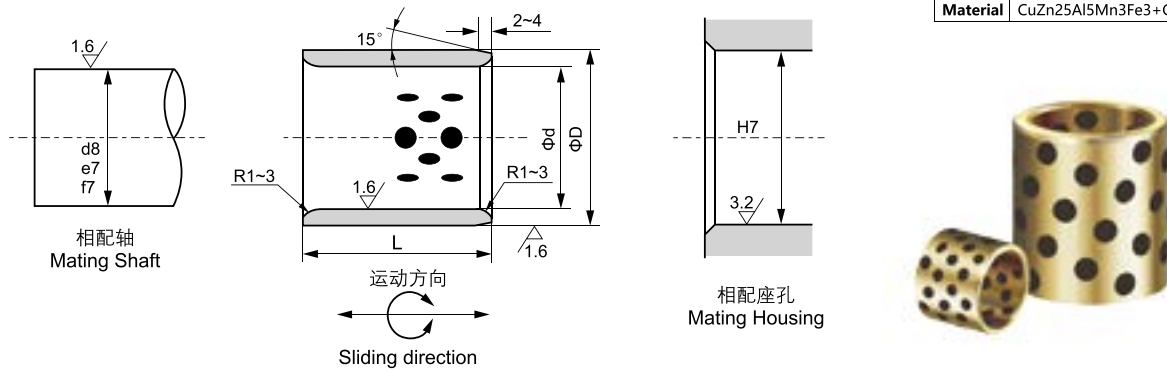

Unit(单位): mm

d	D	IDF7	ODm6	L																						
				8	10	12	15	16	20	25	30	35	40	50	60	70	80	100	120	130	140	150				
6	10	6	$+0.022$ $+0.010$	10	$+0.015$ $+0.006$	0608	0610	0612	0615																	
8	12	8	$+0.028$ $+0.013$	12	$+0.018$ $+0.007$	0808	0810	0812	0815																	
10	14	10		14		1008	1010	1012	1015		1020															
12	18	12		18			1210	1212	1215	1216	1220	1225	1230													
13	19	13		19			1310	1312	1315		1320	1325	1330													
14	20	14		20			1410	1412	1415		1420	1425	1430													
15	21	15	$+0.034$ $+0.016$	21			1510	1512	1515	1516	1520	1525	1530													
16	22	16		22	$+0.021$ $+0.008$		1610	1612	1615	1616	1620	1625	1630	1635	1640											
18	24	18		24				1812		1816	1820	1825	1830	1835	1840											
20	28	20		28			2010	2012	2015	2016	2020	2025	2030	2035	2040	2050										
22	32	22		32				2212	2215		2220	2225	2230													
25	33	25		33				2512	2515	2516	2520	2525	2530	2535	2540	2550	2560									
30	38	30	$+0.041$ $+0.020$	38				3012	3015		3020	3025	3030	3035	3040	3050	3060	3070								
35	45	35		45	$+0.025$ $+0.009$						3520	3525	3530	3535	3540	3550	3560	3570								
40	50	40		50							4020	4025	4030	4035	4040	4050	4060	4070	4080							
45	55	45		55									4530	4535	4540	4550	4560	4570	4580							
50	60	50		60									5030	5035	5040	5050	5060	5070	5080							
50	62	50	$+0.050$ $+0.025$	62									5030A	5035A	5040A	5050A	5060A	5070A	5080A							
50	65	50		65									5030B		5040B	5050B	5060B	5070B	5080B	50100						
55	70	55		70									5530		5540	5550	5560	5570	5580	55100						
60	75	60		75	$+0.030$ $+0.011$								6030	6035	6040	6050	6060	6070	6080							
60	75	60		75									6030A	6035A	6040A	6050A	6060A	6070A	6080A	60100						
63	75	63		75												6360	6370	6380								
65	80	65		80											6530	6540	6550	6560	6570	6580	65100					
70	85	70	$+0.060$ $+0.030$	85									7030	7040	7050	7060	7070	7080	70100							
70	90	70		90									7030A	7040A	7050A	7060A	7070A	7080A	70100A							
75	90	75		90									7530	7540	7550	7560	7570	7580	75100							
75	95	75		95	$+0.035$ $+0.013$									7540A		7560A	7570A	7580A	75100A							
80	96	80		96										8040	8050	8060	8070	8080	80100	80120						
80	100	80		100									8030	8040A	8050A	8060A	8070A	8080A	80100A	80120A						
90	110	90		110									9030	9040	9050	9060	9070	9080	90100	90120						
100	120	100	$+0.071$ $+0.036$	120											10050	10060	10070	10080	100100	100120						
110	130	110		130														11080	110100	110120						
120	140	120		140														12080	120100	120120						120150
125	145	125		145															125100							125150
130	150	130		150	$+0.040$ $+0.015$														130100							
140	160	140	$+0.083$ $+0.043$	160																140100		140130				140150
150	170	150		170																150100						150150
160	180	160		180																160100						160150

# JFB650 自润翻边轴套

OILLESS FLANGE BUSHES



材质	高力黄铜 + 石墨
Material	CuZn25Al5Mn3Fe3+Graphite

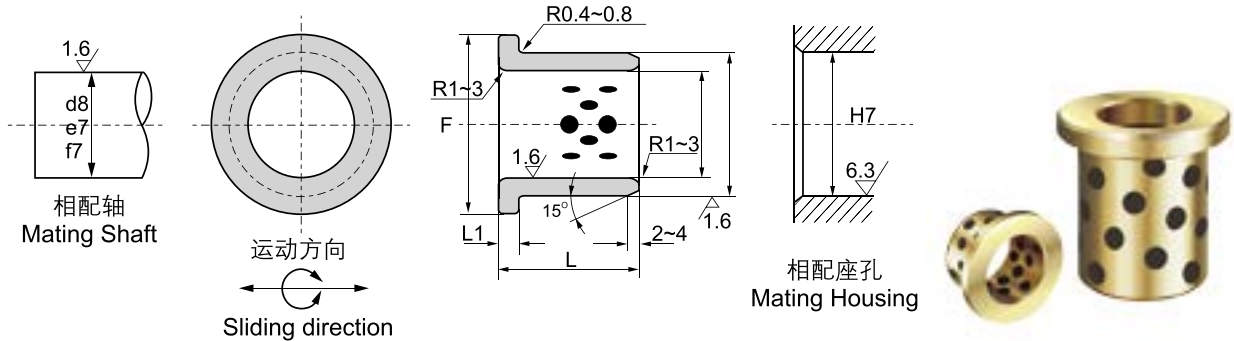

Unit(单位): mm

d	D	IDF7	ODr6	F	L1 -0.10	L -0.10 -0.30											
						15	20	25	30	35	40	50	60	80	100		
10	14	10	+0.040 +0.025	14	+0.034 +0.023	22	2	JFB650 1015	JFB650 1020								
12	18	12		18		25		JFB650 1215	JFB650 1220								
13	19	13		19		26		JFB650 1315	JFB650 1320								
14	20	14	+0.050 +0.032	20		27	3	JFB650 1415	JFB650 1420								
15	21	15		21	+0.041 +0.028	28		JFB650 1515	JFB650 1520	JFB650 1525	JFB650 1530						
16	22	16		22		29		JFB650 1615	JFB650 1620	JFB650 1625	JFB650 1630						
20	30	20		30		40		JFB650 2015	JFB650 2020	JFB650 2025	JFB650 2030		JFB650 2040				
25	35	25	+0.061 +0.040	35		45		JFB650 2515	JFB650 2520	JFB650 2525	JFB650 2530		JFB650 2540				
30	40	30		40		50			JFB650 3020	JFB650 3025	JFB650 3030	JFB650 3035	JFB650 3040	JFB650 3050			
31.5	40	31.5		40	+0.050 +0.034	50			JFB650 3120			JFB650 3135					
35	45	35		45		60	5		JFB650 3520		JFB650 3530		JFB650 3540	JFB650 3550			
40	50	40	+0.075 +0.050	50		65			JFB650 4020		JFB650 4030		JFB650 4040	JFB650 4050			
45	55	45		55		70					JFB650 4530		JFB650 4540	JFB650 4550	JFB650 4560		
50	60	50		60	+0.060 +0.041	75				JFB650 5030		JFB650 5050	JFB650 5050	JFB650 5060			
55	65	55		65		80						JFB650 5540		JFB650 5560			
60	75	60		75	+0.062 +0.043	90						JFB650 6040	JFB650 6050		JFB650 6080		
63	75	63		75		85	7.5								JFB650 6367		
70	85	70	+0.090 +0.060	85		105							JFB650 7050		JFB650 7080		
75	90	75		90	+0.073 +0.051	110								JFB650 7560			
80	100	80		100		120									JFB650 8080	JFB650 80100	
90	110	90		110	+0.076 +0.054	130	10							JFB650 9060	JFB650 9080		
100	120	100	+0.107 +0.072	120		150									JFB650 10080	JFB650 100100	
120	140	120		140	+0.088 +0.063	170									JFB650 12080	JFB650 120100	

# JTW650 止推垫片

OILLESS THRUST WASHERS

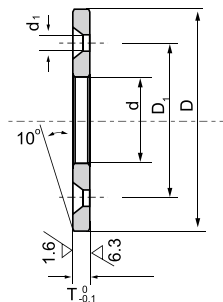
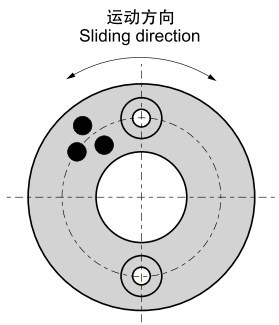

材质	高力黄铜 + 石墨
Material	CuZn25Al5Mn3Fe3+Graphite



Unit(单位): mm

Standard No. 规格	d	D	T <sup>0</sup> <sub>-0.1</sub>	Bolt 螺栓				
				D <sub>1</sub>	Q'ty 数量	Size 尺寸	d <sub>1</sub>	
JTW650-10	10.2	30	3	—	—	—	—	
JTW650-12	12.2	40		3	28	2	M3	3.5
JTW650-13	13.2							
JTW650-14	14.2							
JTW650-15	15.2							
JTW650-16	16.2	50			35	—	—	—
JTW650-16N			—					
JTW650-18	18.2	55	5	35	2	M3	3.5	
JTW650-20	20.2			55	5	—	—	—
JTW650-20N		—						
JTW650-25	25.2	55	5	40	2	M5	6	
JTW650-25N				—				
JTW650-30	30.2	60	7	45	2	M5	6	
JTW650-35	35.2	70		50				
JTW650-40	40.2	80	7	60	2	M6	7	
JTW650-45	45.3	90		67.5				
JTW650-50	50.3	100	8	75	4	M8	9	
JTW650-55	55.3	110		85				
JTW650-60	60.3	120	8	90	4	M8	9	
JTW650-65	65.3	125		95				
JTW650-70	70.3	130	10	100	4	M8	9	
JTW650-75	75.3	140		110				
JTW650-80	80.3	150	10	120	4	M8	9	
JTW650-90	90.5	170		140				
JTW650-100	100.5	190	10	160	4	M10	11	
JTW650-120	120.5	200		175				

# GB650, GB250 自润导向套

## OILLESS GUIDE BUSHES

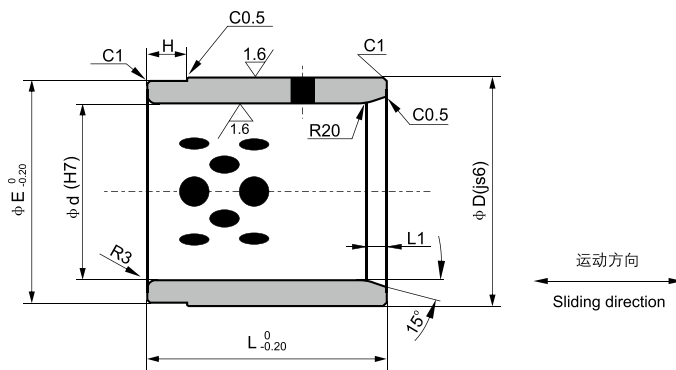

GB650	材质	高力黄铜 + 石墨
	Material	CuZn25Al5Mn3Fe3+Graphite
GB250	材质	FC250 铸铁 + 石墨
	Material	250#+Graphite



Unit(单位): mm

Item	Standard No. 规格	Size 尺寸	ΦD	Φd	L	ΦE	H	L1
1	GB650-30	50 × 30 × 50	50	30	50	49	10	5
2	GB650-40	60 × 40 × 50	60	40	60	59	10	
3	GB650-50	70 × 50 × 50	70	50	75	69	15	
4	GB650-60	80 × 60 × 90	80	60	90	79	20	
5	GB650-80	100 × 80 × 120	100	80	120	99	25	10
6	GB650-100	120 × 100 × 130	120	100	150	119	25	
7	GB650-120	140 × 120 × 180	140	120	180	139	25	

1	GB250-30	50 × 30 × 50	50	30	50	49	10	5
2	GB250-40	60 × 40 × 50	60	40	60	59	10	
3	GB250-50	70 × 50 × 50	70	50	75	69	15	
4	GB250-60	80 × 60 × 90	80	60	90	79	20	
5	GB250-80	100 × 80 × 120	100	80	120	99	25	10
6	GB250-100	120 × 100 × 130	120	100	150	119	25	
7	GB250-120	140 × 120 × 180	140	120	180	139	25	

# JGB 自润滑导向套

OILLESS GUIDE BUSHES

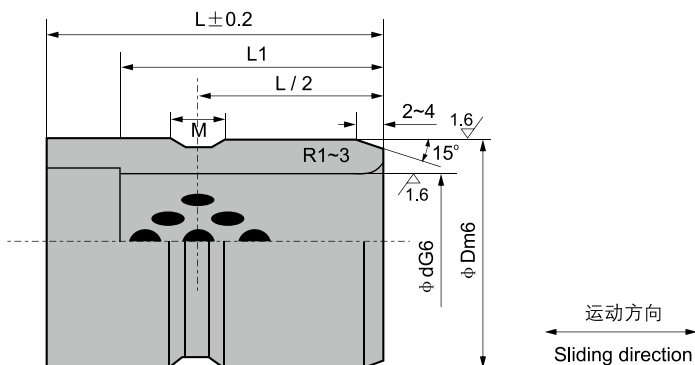

材质	高力黄铜 + 石墨
Material	CuZn25Al5Mn3Fe3+Graphite



Unit(单位): mm

Standard No. 规格	Φd	G6	ΦD	m6	L	L1	M
JGB-12 × 9					9	9	-
JGB-12 × 14	12		18	+0.018 +0.007	14	14	
JGB-12 × 19					19	19	
JGB-12 × 24					24	24	4
JGB-13 × 14	13		20		14	14	
JGB-13 × 19					19	19	
JGB-13 × 24					24	24	
JGB-13 × 29		+0.017 +0.006			29	29	6
JGB-13 × 34					34	30	
JGB-16 × 14	16		25		14	14	
JGB-16 × 19					19	19	4
JGB-16 × 24					24	24	
JGB-16 × 29				+0.021 +0.008	29	29	6
JGB-16 × 34					34	34	
JGB-16 × 39					39	35	
JGB-20 × 14	20		30		14	14	
JGB-20 × 19					19	19	4
JGB-20 × 24					24	24	
JGB-20 × 29		+0.020 +0.007			29	29	
JGB-20 × 34					34	34	6
JGB-20 × 39					39	39	
JGB-20 × 49					49	40	
JGB-25 × 24	25		35		24	24	
JGB-25 × 29					29	29	
JGB-25 × 34					34	34	8
JGB-25 × 39					39	39	
JGB-25 × 49					49	49	
JGB-25 × 59					59	50	
JGB-30 × 29	30	+0.020 +0.007	42	+0.025 +0.009	29	29	
JGB-30 × 34					34	34	
JGB-30 × 39					39	39	
JGB-30 × 49					49	49	8
JGB-30 × 59					59	59	
JGB-30 × 69					69	60	
JGB-30 × 79					79	60	

Standard No. 规格	Φd	G6	ΦD	m6	L	L1	M
JGB-35 × 29					29	29	
JGB-35 × 39	35		48	+0.025 +0.009	34	34	
JGB-35 × 39					39	39	
JGB-35 × 49					49	49	8
JGB-35 × 59					59	59	
JGB-35 × 69					69	69	
JGB-35 × 79					79	70	
JGB-40 × 39	40	+0.025 +0.009	55		39	39	
JGB-40 × 49					49	49	
JGB-40 × 59					59	59	10
JGB-40 × 69					69	69	
JGB-40 × 79					79	79	
JGB-40 × 89				+0.030 +0.011	89	80	
JGB-50 × 49	50		70		49	49	
JGB-50 × 59					59	59	
JGB-50 × 69					69	69	10
JGB-50 × 79					79	79	
JGB-50 × 89					89	89	
JGB-50 × 99					99	90	
JGB-60 × 59	60		80	+0.030 +0.011	59	59	
JGB-60 × 69					69	69	
JGB-60 × 79					79	79	10
JGB-60 × 89					89	89	
JGB-60 × 99					99	90	
JGB-60 × 109					109	90	
JGB-70 × 69	70	+0.029 +0.010	90		69	69	
JGB-70 × 79					79	79	
JGB-70 × 89					89	89	10
JGB-70 × 99					99	99	
JGB-70 × 109					109	100	
JGB-70 × 119				+0.035 +0.013	119	100	
JGB-80 × 69	80		100		69	69	
JGB-80 × 79					79	79	
JGB-80 × 89					89	89	10
JGB-80 × 99					99	99	
JGB-80 × 109					109	100	
JGB-80 × 119					119	100	

# JGBF 自润滑翻边导向套

## OILLESS FLANGED GUIDE BUSHES

材质	高力黄铜 + 石墨
Material	CuZn25Al5Mn3Fe3+Graphite

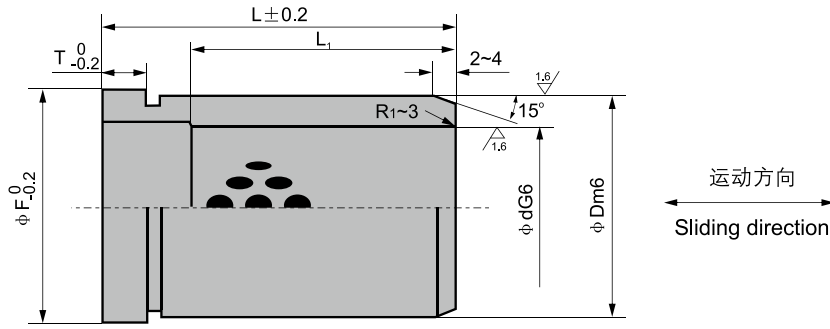

Unit(单位): mm

Standard No. 规格	Φd	G6	ΦD	m6	ΦF	T	L	L <sub>1</sub>						
JGBF-12 × 19							19	19						
JGBF-12 × 24	12		18	+0.018 +0.007	4		24	24						
JGBF-12 × 29							29	29						
JGBF-12 × 34							34	34						
JGBF-13 × 19									25		19	19		
JGBF-13 × 24	13	+0.017 +0.006	20		5		24	24						
JGBF-13 × 29							29							
JGBF-13 × 34							34	25						
JGBF-13 × 39							39							
JGBF-16 × 19	16		25	+0.021 +0.008	30	6	19	19						
JGBF-16 × 24							24	24						
JGBF-16 × 29							29	29						
JGBF-16 × 34							34							
JGBF-16 × 39							39	30						
JGBF-16 × 49							49							
JGBF-20 × 19	20	+0.020 +0.007	30		35	8	19	19						
JGBF-20 × 24							24	24						
JGBF-20 × 29							29	29						
JGBF-20 × 34							34	34						
JGBF-20 × 39							39	39						
JGBF-20 × 49							49	40						
JGBF-20 × 59							59							
JGBF-25 × 24							25		35		40	8	24	24
JGBF-25 × 29													29	29
JGBF-25 × 34													34	34
JGBF-25 × 39	39	39												
JGBF-25 × 49	49	49												
JGBF-25 × 59	59	50												
JGBF-25 × 69			69										99	99
JGBF-30 × 29	30	+0.020 +0.007	42	+0.025 +0.009	47	10							29	29
JGBF-30 × 34													34	34
JGBF-30 × 39													39	39
JGBF-30 × 49							49	49						
JGBF-30 × 59							59	59						
JGBF-30 × 69							69	60						
JGBF-30 × 79			79											

Standard No. 规格	Φd	G6	ΦD	m6	ΦF	T	L	L <sub>1</sub>						
JGBF-35 × 39							39	39						
JGBF-35 × 49							49	49						
JGBF-35 × 59							59	59						
JGBF-35 × 69	35		48	+0.025 +0.009	54	10	69	69						
JGBF-35 × 79							79							
JGBF-35 × 89							89	70						
JGBF-35 × 99							99							
JGBF-40 × 39	40	+0.025 +0.009	55		61	10	39	39						
JGBF-40 × 49							49	49						
JGBF-40 × 59							59	59						
JGBF-40 × 69							69	69						
JGBF-40 × 79							79	79						
JGBF-40 × 89							89							
JGBF-40 × 99							99	80						
JGBF-40 × 109							109							
JGBF-50 × 49							50		70	+0.030 +0.011	76	12	49	49
JGBF-50 × 59													59	59
JGBF-50 × 69	69	69												
JGBF-50 × 79	79	79												
JGBF-50 × 89	89	89												
JGBF-50 × 99	99													
JGBF-50 × 109	109	90												
JGBF-50 × 119	119													
JGBF-60 × 99	60		80		86	15							99	99
JGBF-60 × 109													109	109
JGBF-60 × 119							119	110						
JGBF-60 × 129							129							
JGBF-60 × 149							149							
JGBF-70 × 99							70	+0.029 +0.010	90		96	15	99	99
JGBF-70 × 109	109	109												
JGBF-70 × 119	119	119												
JGBF-70 × 129	129	120												
JGBF-70 × 149	149													
JGBF-80 × 99	80		100	+0.035 +0.013	108	15							99	99
JGBF-80 × 109							109	109						
JGBF-80 × 119							119	119						
JGBF-80 × 129							129	120						
JGBF-80 × 149							149							

# JEGB, JEGB-K 射出座导套

OILLESS EJECTOR GUIDE BUSHES

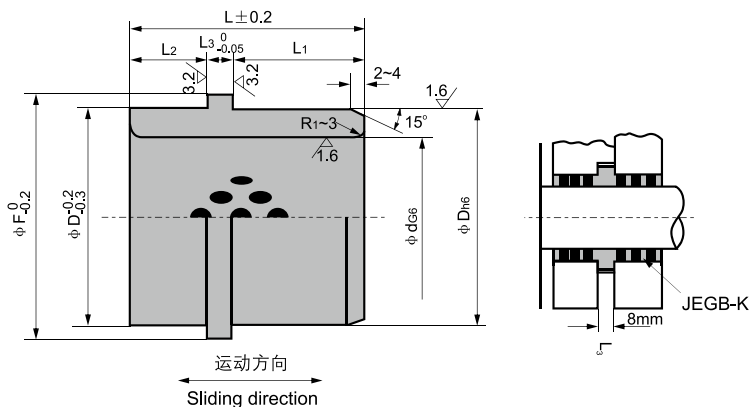

材质	高力黄铜 + 石墨
Material	CuZn25Al5Mn3Fe3+Graphite



Unit(单位): mm

Standar No. 规格	Φ d	G6	Φ D	h6	Φ F	L	L <sub>1</sub>	L <sub>2</sub>	L <sub>3</sub>		
JEGB-10 × 24	10	+0.014	16	0	21	24	10				
JEGB-10 × 28		+0.005				28	14				
JEGB-12 × 26	12		18			26	12				
JEGB-12 × 28						28	14				
JEGB-13 × 26	13		22		25	26	12				
JEGB-13 × 28						28	14				
JEGB-13 × 33						33	18				
JEGB-13 × 38						38	24				
JEGB-16 × 26	16		25	0	30	26	12	10			
JEGB-16 × 28						28	14				
JEGB-16 × 33						33	19				
JEGB-16 × 38						38	24				
JEGB-20 × 26	20		30		35	26	12				
JEGB-20 × 28						28	14				
JEGB-20 × 33						33	19				
JEGB-20 × 38						38	24				
JEGB-25 × 26	25	+0.020	35		40	26	12		4		
JEGB-25 × 28						28	14				
JEGB-25 × 33						33	19				
JEGB-25 × 38						38	24				
JEGB-30 × 33	30		40	0	45	33	14				
JEGB-30 × 38						38	19				
JEGB-30 × 43						43	24				
JEGB-32 × 38						38	19				
JEGB-32 × 43	32		42		47	43	24	15			
JEGB-32 × 48						48	29				
JEGB-35 × 38	35	+0.025	46		50	38	19				
JEGB-35 × 43						43	24				
JEGB-35 × 48						48	29				
JEGB-40 × 48						48	24				
JEGB-40 × 53	40		52	0	57	53	29	20			
JEGB-50 × 48						48	24				
JEGB-50 × 53	50		62	-0.019	67	53	29				
JEGB-K-30 × 37	30	+0.020	42	0	47	37	14	15			
JEGB-K-30 × 42						42	19				
JEGB-K-30 × 47						47	24				
JEGB-K-30 × 52						52	29				
JEGB-K-40 × 53	40		55	0	60	53	20	25			
JEGB-K-40 × 57						57	24				
JEGB-K-40 × 60						60	32			20	8
JEGB-K-40 × 67						67	29			30	
JEGB-K-40 × 70	50	+0.025	50		55	70	42	20			
JEGB-K-50 × 67						67	29	30			
JEGB-K-50 × 87	50		62	0	67	87	39	40			
JEGB-K-60 × 67						67	29	30			
JEGB-K-60 × 87	60	+0.029	74	-0.019	82	87	39	40			



# JOSG 射出头自润导套

## EJECTOR GUIDE BUSHES

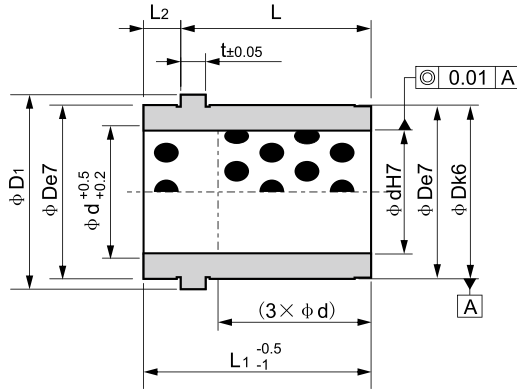

材质	高力黄铜 + 石墨
Material	CuZn25Al5Mn3Fe3+Graphite

Sliding directions  
运动方向



Unit(单位): mm

Standar No. 规格	d	L	L <sub>1</sub>	L <sub>2</sub>	t	D	Tolerance		D <sub>1</sub>	L <sub>1</sub>	
							e7	k6			
JOSG-9x15	9	12	15	3	3	14	-0.032 -0.050	+0.012 +0.001	16	9	+0.015 0
JOSG-9x20	"	17	20	"	"	"	"	"	"	"	"
JOSG-9x25	"	22	25	"	"	"	"	"	"	"	"
JOSG-9x30	"	27	30	"	"	"	"	"	"	"	"
JOSG-9x39	"	36	39	"	"	"	"	"	"	"	"
JOSG-10x15	10	12	15	"	"	"	"	"	"	10	"
JOSG-10x20	"	17	20	"	"	"	"	"	"	"	"
JOSG-10x25	"	22	25	"	"	"	"	"	"	"	"
JOSG-10x30	"	27	30	"	"	"	"	"	"	"	"
JOSG-10x39	"	36	39	"	"	"	"	"	"	"	"
JOSG-14x26	14	17	26	9	6	20	-0.040 -0.061	+0.015 +0.002	25	14	+0.018 0
JOSG-14x31	"	22	31	"	"	"	"	"	"	"	"
JOSG-14x36	"	27	36	"	"	"	"	"	"	"	"
JOSG-14x45	"	36	45	"	"	"	"	"	"	"	"
JOSG-14x55	"	46	55	"	"	"	"	"	"	"	"
JOSG-14x65	"	56	65	"	"	"	"	"	"	"	"
JOSG-15x26	15	17	26	"	"	"	"	"	"	15	"
JOSG-15x31	"	22	31	"	"	"	"	"	"	"	"
JOSG-15x36	"	27	36	"	"	"	"	"	"	"	"
JOSG-15x45	"	36	45	"	"	"	"	"	"	"	"
JOSG-15x55	"	46	55	"	"	"	"	"	"	"	"
JOSG-15x65	"	56	65	"	"	"	"	"	"	"	"
JOSG-18x26	18	17	26	"	"	26	"	"	31	18	"
JOSG-18x31	"	22	31	"	"	"	"	"	"	"	"
JOSG-18x36	"	27	36	"	"	"	"	"	"	"	"
JOSG-18x45	"	36	45	"	"	"	"	"	"	"	"
JOSG-18x55	"	46	55	"	"	"	"	"	"	"	"
JOSG-18x65	"	56	65	"	"	"	"	"	"	"	"
JOSG-18x75	"	66	75	"	"	"	"	"	"	"	"
JOSG-20x26	20	17	26	"	"	"	"	"	20	+0.021 0	"
JOSG-20x31	"	22	31	"	"	"	"	"	"	"	"
JOSG-20x36	"	27	36	"	"	"	"	"	"	"	"
JOSG-20x45	"	36	45	"	"	"	"	"	"	"	"
JOSG-20x55	"	46	55	"	"	"	"	"	"	"	"
JOSG-20x65	"	56	65	"	"	"	"	"	"	"	"
JOSG-20x75	"	66	75	"	"	"	"	"	"	"	"
JOSG-22x26	22	17	26	"	"	30	"	"	35	22	"
JOSG-22x31	"	22	31	"	"	"	"	"	"	"	"
JOSG-22x36	"	27	36	"	"	"	"	"	"	"	"
JOSG-22x45	"	36	45	"	"	"	"	"	"	"	"
JOSG-22x55	"	46	55	"	"	"	"	"	"	"	"
JOSG-22x65	"	56	65	"	"	"	"	"	"	"	"
JOSG-22x75	"	66	75	"	"	"	"	"	"	"	"
JOSG-22x85	"	76	85	"	"	"	"	"	"	"	"
JOSG-22x95	"	86	95	"	"	"	"	"	"	"	"

Standar No. 规格	d	L	L <sub>1</sub>	L <sub>2</sub>	t	D	Tolerance		D <sub>1</sub>	L <sub>1</sub>	
							e7	k6			
JOSG-24x26	24	17	26	9	6	30	-0.040 -0.061	+0.015 +0.002	35	24	+0.021
JOSG-24x31	"	22	31	"	"	"	"	"	"	"	"
JOSG-24x36	"	27	36	"	"	"	"	"	"	"	"
JOSG-24x45	"	36	45	"	"	"	"	"	"	"	"
JOSG-24x55	"	46	55	"	"	"	"	"	"	"	"
JOSG-24x65	"	56	65	"	"	"	"	"	"	"	"
JOSG-24x75	"	66	75	"	"	"	"	"	"	"	"
JOSG-24x85	"	76	85	"	"	"	"	"	"	"	"
JOSG-24x95	"	86	95	"	"	"	"	"	"	"	"
JOSG-30x36	30	27	36	"	"	42	-0.050	-0.048	47	30	"
JOSG-30x45	"	36	45	"	"	"	"	"	"	"	"
JOSG-30x55	"	46	55	"	"	"	"	"	"	"	"
JOSG-30x65	"	56	65	"	"	"	"	"	"	"	"
JOSG-30x75	"	66	75	"	"	"	"	"	"	"	"
JOSG-30x85	"	76	85	"	"	"	"	"	"	"	"
JOSG-30x95	"	86	95	"	"	"	"	"	"	"	"
JOSG-30x105	"	96	105	"	"	"	"	"	"	"	"
JOSG-30x125	"	116	125	"	"	"	"	"	"	"	"
JOSG-32x36	32	27	36	"	"	"	"	"	"	32	+0.025
JOSG-32x45	"	36	45	"	"	"	"	"	"	"	"
JOSG-32x55	"	46	55	"	"	"	"	"	"	"	"
JOSG-32x65	"	56	65	"	"	"	"	"	"	"	"
JOSG-32x75	"	66	75	"	"	"	"	"	"	"	"
JOSG-32x85	"	76	85	"	"	"	"	"	"	"	"
JOSG-32x95	"	86	95	"	"	"	"	"	"	"	"
JOSG-32x105	"	96	105	"	"	"	"	"	"	"	"
JOSG-32x125	"	116	125	"	"	"	"	"	"	"	"
JOSG-40x68	40	56	68	12	10	54	-0.060 -0.090	+0.021 +0.002	60	40	"
JOSG-40x78	"	66	78	"	"	"	"	"	"	"	"
JOSG-40x88	"	76	88	"	"	"	"	"	"	"	"
JOSG-40x98	"	86	98	"	"	"	"	"	"	"	"
JOSG-40x108	"	96	108	"	"	"	"	"	"	"	"
JOSG-40x128	"	116	128	"	"	"	"	"	"	"	"
JOSG-40x148	"	136	148	"	"	"	"	"	"	"	"
JOSG-40x168	"	156	168	"	"	"	"	"	"	"	"
JOSG-42x68	42	56	68	"	"	"	"	"	"	42	"
JOSG-42x78	"	66	78	"	"	"	"	"	"	"	"
JOSG-42x88	"	76	88	"	"	"	"	"	"	"	"
JOSG-42x98	"	86	98	"	"	"	"	"	"	"	"
JOSG-42x108	"	96	108	"	"	"	"	"	"	"	"
JOSG-42x128	"	116	128	"	"	"	"	"	"	"	"
JOSG-42x148	"	136	148	"	"	"	"	"	"	"	"
JOSG-42x168	"	156	168	"	"	"	"	"	"	"	"

# JESF 自润滑板

## OILLESS WEAR PLATE

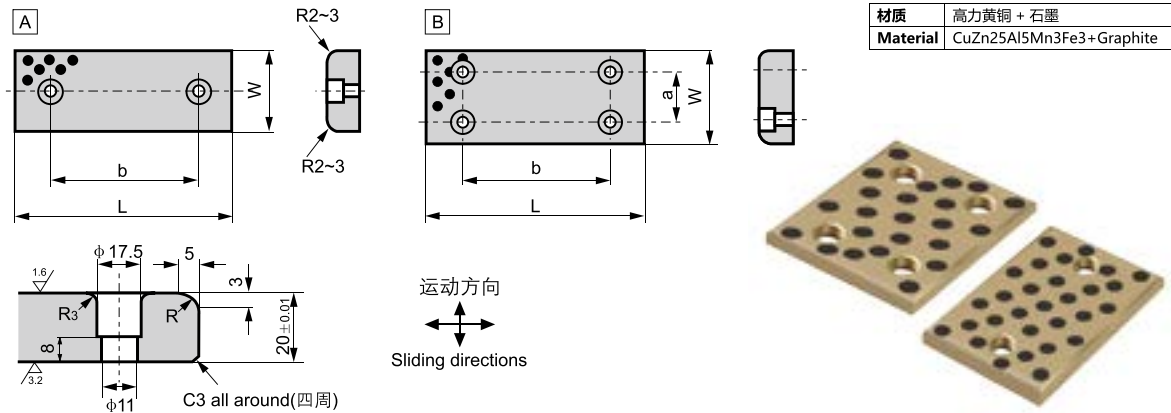

Unit(单位): mm

Standard No. 规格	W	L	a	b	Sketch 图示
JESF-48 × 75		75		45	
JESF-48 × 100		100		50	
JESF-48 × 125	48	125	—	75	
JESF-48 × 150		150		100	
JESF-48 × 200		200		150	
JESF-75 × 75		75		25	A
JESF-75 × 100		100		50	
JESF-75 × 125	75	125	—	75	
JESF-75 × 150		150		100	
JESF-75 × 200		200		150	
JESF-75 × 250		250		200	
JESF-100 × 100		100		50	
JESF-100 × 125		125		75	
JESF-100 × 150	100	150	50	100	
JESF-100 × 200		200		150	
JESF-100 × 250		250		200	
JESF-100 × 300		300		200	
JESF-125 × 125		125		75	B
JESF-125 × 150		150		100	
JESF-125 × 200	125	200	50	150	
JESF-125 × 250		250		200	
JESF-125 × 300		300		200	
JESF-150 × 150		150		100	
JESF-150 × 200	150	200	100	150	
JESF-150 × 250		250		200	

# JMWP 自润滑板

## OILLESS MIDDLE WEAR PLATE

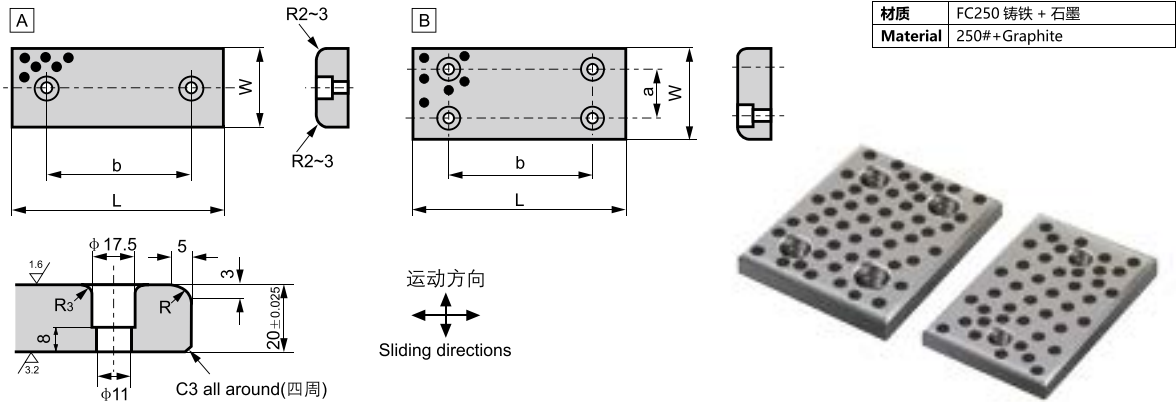

Standard No. 规格	W	L	a	b	Sketch 图示	
JMWP-28 × 75	28	75	—	45		
JMWP-28 × 100		100				
JMWP-28 × 120		125				
JMWP-28 × 150		150				
JMWP-28 × 200		200				
JMWP-38 × 75	38	75	—	45		
JMWP-38 × 100		100				
JMWP-38 × 125		125				
JMWP-38 × 150		150				
JMWP-38 × 200		200				
JMWP-48 × 75	48	75	—	45		
JMWP-48 × 100		100				
JMWP-48 × 125		125				
JMWP-48 × 150		150				
JMWP-48 × 200		200				
JMWP-58 × 75	58	75	—	45		
JMWP-58 × 100		100				
JMWP-58 × 150		150				
JMWP-75 × 75		75		75	—	25
JMWP-75 × 100				100		
JMWP-75 × 125	125					
JMWP-75 × 150	150					
JMWP-75 × 200	200					
JMWP-100 × 100	100	100	50	50		
JMWP-100 × 125		125				
JMWP-100 × 150		150				
JMWP-100 × 200		200				
JMWP-100 × 250		250				
JMWP-125 × 125	125	125	50	75		
JMWP-125 × 150		150				
JMWP-125 × 200		200				
JMWP-125 × 250		250				
JMWP-150 × 150		150		150	100	100
JMWP-150 × 200	200					
JMWP-150 × 250	250					
JMWP-150 × 300	300					
JMWP-200 × 200	200		200	150		150
JMWP-200 × 250		250				
JMWP-200 × 300		300				

# JUWP 自润滑板

## OILLESS THIN WEAR PLATE

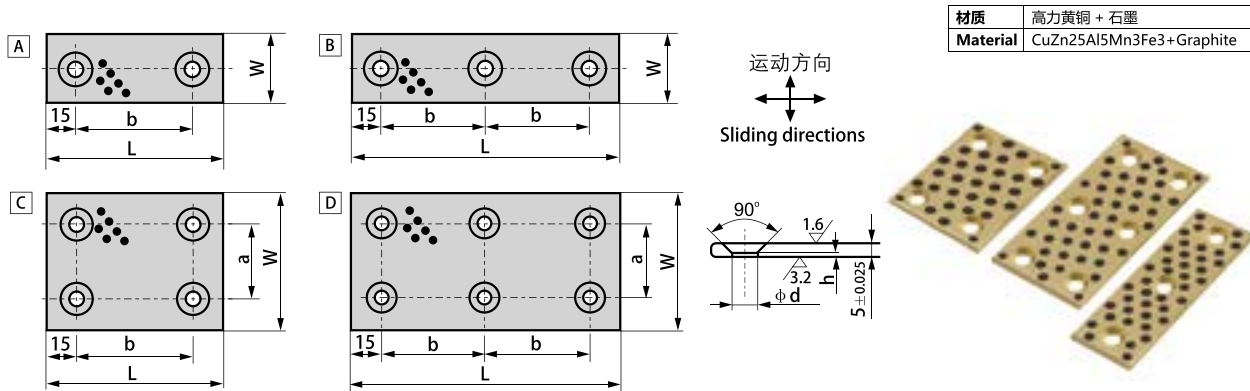

Unit(单位): mm

Standard No. 规格	W	d	h	L	a	b	Sketch 图示	
JUWP-18 × 50	18	6.5	1.5	50	—	20	A	
JUWP-18 × 75				75		45		
JUWP-18 × 100				100		70		
JUWP-18 × 150				150		60		B
JUWP-28 × 50	28			50	—	20	A	
JUWP-28 × 75				75		45		
JUWP-28 × 100				100		70		
JUWP-28 × 150				150		60		B
JUWP-38 × 50	38			50	—	20	A	
JUWP-38 × 75				75		45		
JUWP-38 × 100				100		70		
JUWP-38 × 150				150		60		B
JUWP-48 × 75	48	10	0.8	75	—	45	A	
JUWP-48 × 100				100		70		
JUWP-48 × 125				125		95		
JUWP-48 × 150				150		60		B
JUWP-75 × 75	75			75	45	45	C	
JUWP-75 × 100				100		70		
JUWP-75 × 125				125		95		
JUWP-75 × 150				150		60		D
JUWP-100 × 100	100			100	70	70	C	
JUWP-100 × 125				125		95		
JUWP-100 × 150				150		60		D

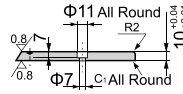
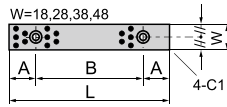

材质	高力黄铜 + 石墨
Material	CuZn25Al5Mn3Fe3+Graphite

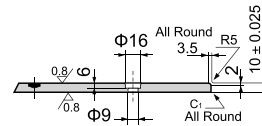
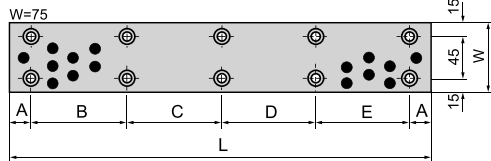
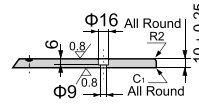
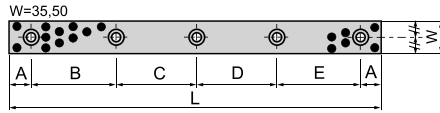

Unit(单位): mm

Standard No. 规格	W 宽度	L 长度	A	B	C	D	E	Fiat Head Screw 平头螺钉	No. of Holes 孔数
JSP-1875	18	75	15	45				M6	2
JSP-18100	18	100	25	60				M6	2
JSP-18125	18	125	25	75				M6	2
JSP-18150	18	150	25	100				M6	2
JSP-2875	28	75	15	45				M6	2
JSP-28100	28	100	25	50				M6	2
JSP-28125	28	125	25	75				M6	2
JSP-28150	28	150	25	100				M6	2
JSP-35100	35	100	20	60				M8	2
JSP-35150	35	150	20	55	55			M8	3
JSP-35200	35	200	20	55	50	55		M8	4
JSP-35250	35	250	20	70	70	70		M8	4
JSP-35300	35	300	20	65	65	65	65	M8	5
JSP-35350	35	350	20	80	75	75	80	M8	5
JSP-3875	38	75	15	45				M6	2
JSP-38100	38	100	25	50				M6	2
JSP-38125	38	125	25	75				M6	2
JSP-38150	38	150	25	100				M6	2
JSP-4875	48	75	15	45				M6	2
JSP-48100	48	100	25	50				M6	2
JSP-48125	48	125	25	75				M6	2
JSP-48150	48	150	25	100				M6	2
JSP-50100	50	100	20	60				M8	2
JSP-50150	50	150	20	55	55			M8	3
JSP-50200	50	200	20	55	50	55		M8	4
JSP-50250	50	250	20	70	70	70		M8	4
JSP-50300	50	300	20	65	65	65	65	M8	5
JSP-50400	50	400	20	90	90	90	90	M8	5
JSP-75150	75	150	20	110				M8	4
JSP-75200	75	200	20	80	80			M8	6
JSP-75250	75	250	20	105	105			M8	6
JSP-75300	75	300	20	85	90	85		M8	8
JSP-75400	75	400	20	120	120	120		M8	8
JSP-75500	75	500	20	115	115	115	115	M8	10

# JCUW, JCUF 凸轮上滑板

## OILLESS CAM UPPER PLATE

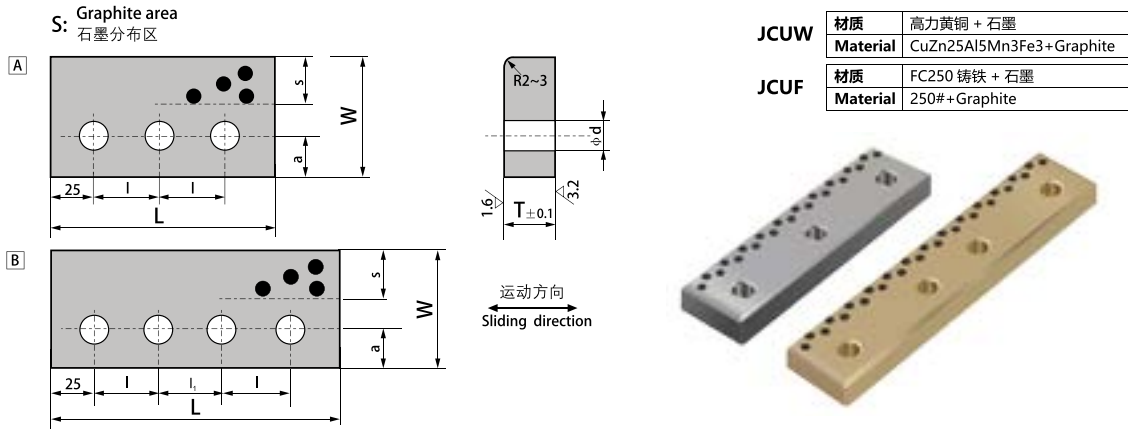

Unit(单位): mm

Standard No. 规格	T	L	W	l	l <sub>1</sub>	a	s	Φd	Sketch 图示
JCUW-20 × 150	20	150	52	50	—	20	12	13	A
JCUW-20 × 200		200		75	50				B
JCUW-20 × 250		250		50	B				
JCUW-30 × 150	30	150	72	50	—	20	22	18	A
JCUW-30 × 200		200		75	50				B
JCUW-30 × 250		250		50	B				
JCUW-35 × 150	35	150	77	50	—	20	27	18	A
JCUW-35 × 200		200		75	50				B
JCUW-35 × 250		250		50	B				
JCUW-40 × 150	40	150	82	50	—	20	32	18	A
JCUW-40 × 200		200		75	50				B
JCUW-40 × 250		250		50	50				B
JCUW-40 × 150D		150		—	—				A
JCUW-40 × 200D		200		105	50				—
JCUW-40 × 250D		250		75	50				B
JCUF-20 × 150	20	150	52	50	—	20	12	13	A
JCUF-20 × 200		200		75	50				B
JCUF-20 × 250		250		50	B				
JCUF-30 × 150	30	150	72	50	—	20	22	18	A
JCUF-30 × 200		200		75	50				B
JCUF-30 × 250		250		50	B				
JCUF-35 × 150	35	150	77	50	—	20	27	18	A
JCUF-35 × 200		200		75	50				B
JCUF-35 × 250		250		50	B				
JCUF-40 × 150	40	150	82	50	—	20	32	18	A
JCUF-40 × 200		200		75	50				B
JCUF-40 × 250		250		50	50				B
JCUF-40 × 150D		150		—	—				A
JCUF-40 × 200D		200		105	50				—
JCUF-40 × 250D		250		75	50				B

# JSPW, JSPS 凸轮行程滑板

## CAM STROKE PLATE

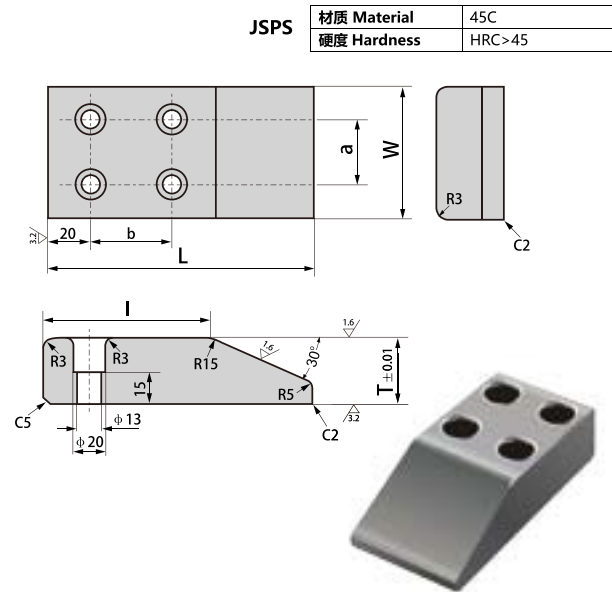
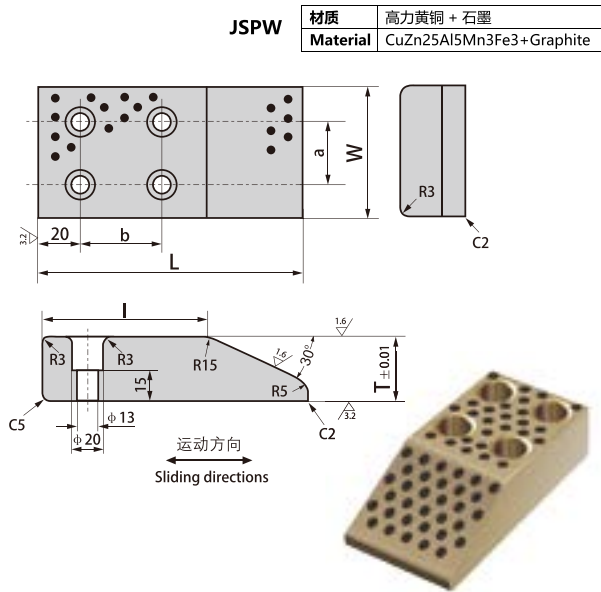

Unit(单位): mm

Standard No. 规格	W	L	T	l	a	b
JSPW-75 × 130	75	130	30	95	40	50
JSPW-75 × 150		150	45	90		45
JSPW-75 × 170		170	60	90		45
JSPW-75 × 200		200	60	120		75
JSPW-100 × 130	100	130	30	95	60	50
JSPW-100 × 150		150	45	90		45
JSPW-100 × 170		170	60	90		45
JSPW-100 × 200		200	60	120		75
JSPW-125 × 130	125	130	30	95	85	50
JSPW-125 × 150		150	45	90		45
JSPW-125 × 170		170	60	120		75
JSPW-125 × 200		200	60	120		75
JSPW-150 × 130	150	130	30	95	110	50
JSPW-150 × 150		150	45	90		45
JSPW-150 × 170		170	60	90		45
JSPW-150 × 200		200	60	120		75
JSPS-75 × 130	75	130	30	95	40	50
JSPS-75 × 150		150	45	90		45
JSPS-75 × 170		170	60	90		45
JSPS-75 × 200		200	60	120		75
JSPS-100 × 130	100	130	30	95	60	50
JSPS-100 × 150		150	45	90		45
JSPS-100 × 170		170	60	90		45
JSPS-100 × 200		200	60	120		75
JSPS-125 × 130	125	130	30	95	85	50
JSPS-125 × 150		150	45	90		45
JSPS-125 × 170		170	60	120		75
JSPS-125 × 200		200	60	120		75
JSPS-150 × 130	150	130	30	95	110	50
JSPS-150 × 150		150	45	90		45
JSPS-150 × 170		170	60	90		45
JSPS-150 × 200		200	60	120		75

# JSL L型自润滑板

## OILLESS SHAPED PLATE

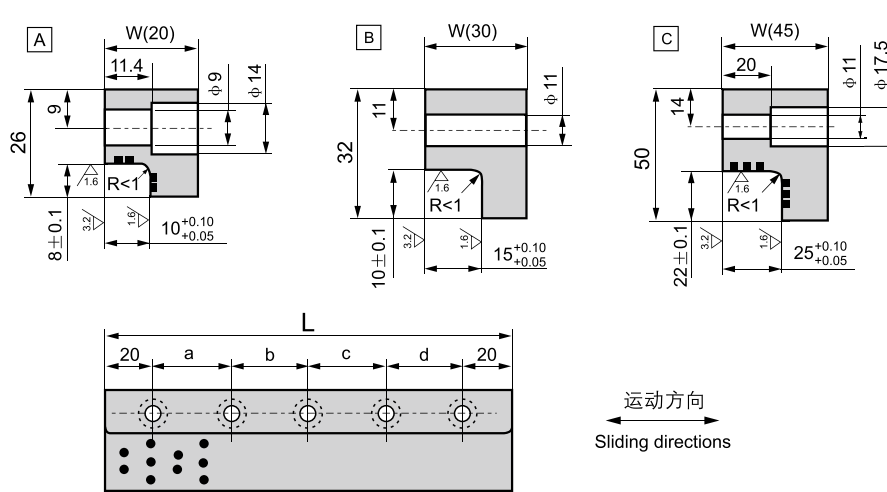
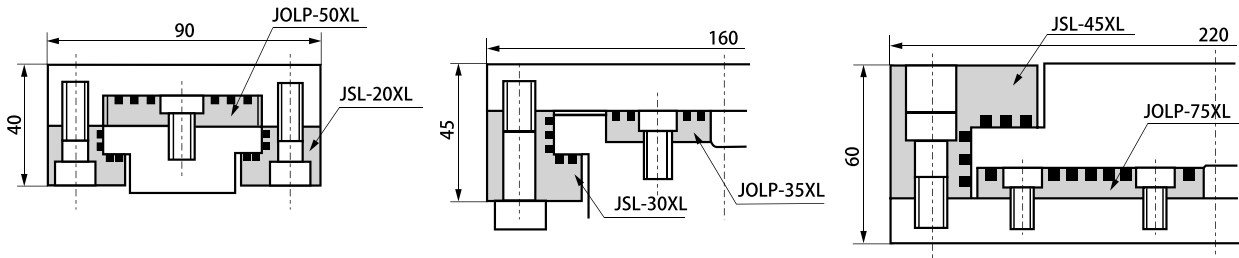

材质	高力黄铜 + 石墨
Material	CuZn25Al5Mn3Fe3+Graphite

Unit(单位): mm

Standard No. 规格	W	L	Bolt location 螺栓位置				Bolt 螺栓		Sketch 图示
			a	b	c	d	Type 规格	Q' ty 数量	
JSL-20 × 100	20	100	60	—	—	—	M8	2	A
JSL-20 × 150		150	55	55	—	—		3	
JSL-20 × 200		200	55	50	55	—		4	
JSL-30 × 100	30	100	60	—	—	—	M10	2	B
JSL-30 × 150		150	55	55	—	—		3	
JSL-30 × 200		200	55	50	55	—		4	
JSL-30 × 250	45	250	70	70	70	—	M10	4	C
JSL-45 × 200		200	55	50	55	—		4	
JSL-45 × 250		250	70	70	70	—		4	
JSL-45 × 300	45	300	65	65	65	65	M10	5	C
JSL-45 × 350		350	80	75	75	80		5	



# JGL, JGLX 自润导轨

## OILLESS GUIDE PAIR

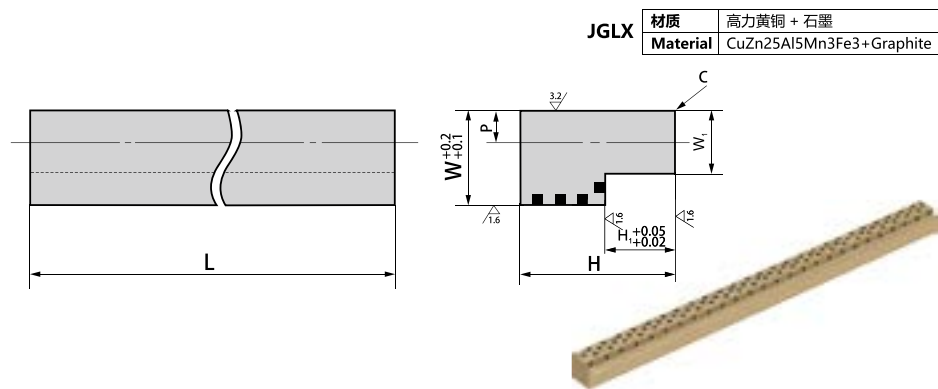
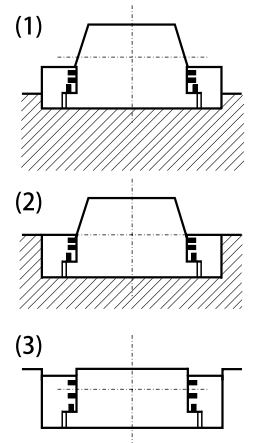
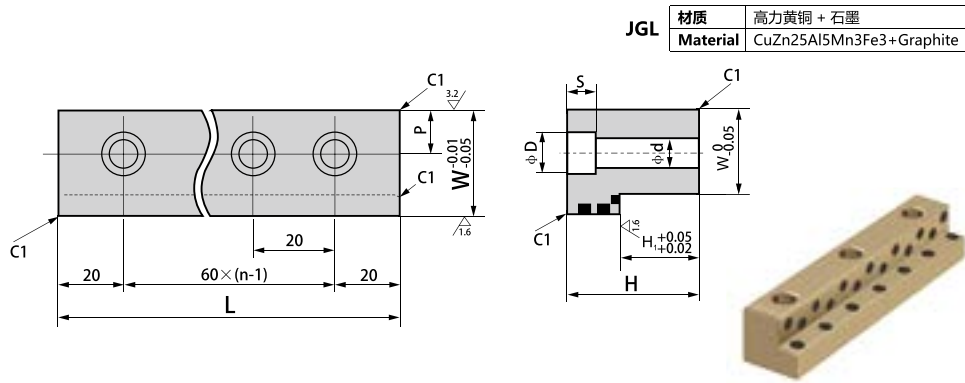

Unit(单位): mm

Standard No. 规格	W	W <sub>1</sub>	L	H	H <sub>1</sub>	n	p	ΦD	Φd	S	Standard No. 规格	W	W <sub>1</sub>	H	H <sub>1</sub>	L	Recom. Bolt 螺栓	
																	P	Size 尺寸
JGL-100 × 30			100			2					JGLX-20 × 15			15				
JGL-160 × 30			160	30	15	3					JGLX-20 × 20			20	5			
JGL-220 × 30	23	15	220			4	7.5	11	7	7	JGLX-20 × 25	20	14.5	25			8	
JGL-100 × 41			100		2	JGLX-20 × 23					23							
JGL-160 × 41			160	41	26	3					JGLX-20 × 28			28	8			
JGL-220 × 41			220			4					JGLX-25 × 28			28			M8	
JGL-100 × 25			100			2					JGLX-25 × 33	25	17.5	33	10			
JGL-160 × 25			160	25	10	3					JGLX-25 × 43					43		
JGL-220 × 25			220			4	10	18	11	13	JGLX-30 × 38			38		320	10	
JGL-100 × 35			100			2					JGLX-30 × 43	30	19	43				
JGL-160 × 35	28	20	160	35	15	3					JGLX-30 × 53					53	15	
JGL-220 × 35					220			4				JGLX-35 × 43			43			
JGL-100 × 56			100			2					JGLX-35 × 53	35	23	53			12	M10
JGL-160 × 56			160	56	26	3	10	14	9	10	JGLX-35 × 63					63		
JGL-220 × 56			220			4					JGLX-40 × 45			45				
											JGLX-40 × 55	40	28	55	20		14	M12
										JGLX-40 × 65						65		

## SF-1 无油润滑轴承 SELF-LUBRICATING BEARING

(SF-1 SF-1T SF-1W SF-1P SF-1D SF-1B SF-1SS SF-1S)



该产品以优质的低碳钢板为基体，中间烧结多孔青铜层，表面轧制聚四氟乙烯 (PTFE) 和 (Pb) 的混合物。它能提供较好的自润滑、耐磨损、低摩擦等性能，充分发挥了金属和多元素聚合物的优点。产品应用于印刷机械、纺织机械、烟草机械、健身器等。

The product is made of high quality low-carbon steel backing with sintering porous bronze in its interlayer and the compound of PTFE and Pb its surface. It can offer the good properties self-lubricating, anti-abrasion, low-friction, fully developing the advantages of metal and multi-element polymer. It is applied to the printing, woven, tobacco and gymnastic machinery, etc.

最大承载压力	Load capacity	140N/mm <sup>2</sup>
适应温度范围	Temperature limit	-195°C ~ +270°C
最高滑动速度	Speed limit	4.5M/s
摩擦系数	Friction coef	0.04-0.20
允许最高 PV 值(干)	PV limit (dry)	3.6N/mm <sup>2</sup> · m/s
允许最高 PV 值(油)	PV limit (oil)	50N/mm <sup>2</sup> · m/s

## SF-2 边界润滑轴承 PRELUBRICATED BEARINGS

(SF-2 SF-2Y)



该产品是以优质低碳钢板为基体，中间烧结一层多孔青铜层，表面轧制聚甲醛 (PTFE) 和 (Pb) 的混合物。能提供较好的承载性和耐磨损性。产品应用于汽车底盘、锻压机床、冶金机械、矿山机械、水利机械、轧钢行业等。

The product is made of high quality low-carbon steel with sintering porous bronze as its interlayer, and the compound of polyoxymethylene (POM) & Pb as its surface. It can offer the good capacity and wear-resistant. The product is applied to vehicle chassis, forging and pressing machine, metallurgical machinery, mining machinery, hydraulic industry and rolling steel industry, etc.

最大承载压力	Load capacity	140N/mm <sup>2</sup>
适应温度范围	Temperature limit	-40°C ~ +130°C
最高滑动速度	Speed limit	2.5M/s
摩擦系数	Friction coef	0.05-0.25
允许最高 PV 值(干)	PV limit (dry)	2.8N/mm <sup>2</sup> · m/s
允许最高 PV 值(油)	PV limit (oil)	22N/mm <sup>2</sup> · m/s

## FB090 青铜轴承 WRAPPED BRONZE BEARINGS



该产品以特殊配方的高密度铜合金为基体，表面轧制菱形或球形油穴，它有高密度，良好承载力及很好的耐磨性。产品适用于起重机械、建筑机械、采矿机械等。

The product is based on high density copper alloy of special formula. The alloy surface is rolled to diamond or global oil grooves. It has density, good load capacity and wear-resistant. The product is applied to lifting machinery, construction machinery and mining machinery, etc.

基体材质	Base material	CuSn8P0.3
硬度	Hardness	HB(90-120)
最大承载压力	Load capacity	150N/mm <sup>2</sup>
适用温度范围	Temperature limit	-100-+120°C
最高滑动速度	Speed limit	2.5N/mm <sup>2</sup> · m/s
允许最高 PV 值(油)	PV limit (oil)	16N/mm <sup>2</sup> · m/s

## FB092 青铜轴承 WRAPPED BRONZE BEARINGS



该产品是在 FB-090 材料的基础上改进而成，表面按一定角度和密度有序地排列润滑通孔，它具有延长使用期及润滑间隔频率，减少磨损等优点。

The product is improved form FB090. The hole is arranged on the surface according to certain angle and density. It can delay life, low lubricating frequency and decrease wear, etc.

基体材质	Base material	CuSn8P0.3
硬度	Hardness	HB(90-120)
最大承载压力	Load capacity	150N/mm <sup>2</sup>
适用温度范围	Temperature limit	-100-+120°C
最高滑动速度	Speed limit	2.5N/mm <sup>2</sup> · m/s
允许最高 PV 值(油)	PV limit (oil)	70N/mm <sup>2</sup> · m/s

## FB08G 固体润滑轴承 SOLID LUBRICANT BEARINGS



FB08G 固体润滑轴承是以 JF-800 双金属材料为基体，再埋入特殊固体润滑剂制作成的新型滑动轴承。由于高强度承载的合金材料作基体，并经过严格选择的高分子填充材料为耐磨剂，合理的螺旋角度菱形块状均布的润滑面，润滑面积达 25%，因此，能发挥超群的低摩擦，良好的润滑性和抗磨耗性。该产品已广泛应用于起重、发电机、升降机、吊车及冶金机械等行业。

FB08G is a kind of steel-lead bronze alloys based bearing, which is embedded with particular formulation of solid lubricants. Owing to the high strength, high load capacity and the spirally distributed diamond type of the embedded solid lubricant, the high temperature resistant action as extraordinary exploited. The lubrication area of the bearing surface is being about 25%. This type of bearing is particularly applied in starting motor for automobiles, generators cranes and those machines in metallurgical industry.

最大承载压力	Load capacity	150N/mm <sup>2</sup>
适应温度范围	Temperature limit	-100°C ~ +200°C
最高滑动速度	Speed limit	1.5M/s
摩擦系数	Friction coef	0.06-0.25
允许最高 PV 值(干)	PV limit (dry)	2.5N/mm <sup>2</sup> · m/s
允许最高 PV 值(油)	PV limit (oil)	15N/mm <sup>2</sup> · m/s

## FB09G 青铜固体润滑轴承 SOLID LUBRICANT BEARINGS



FB09G 青铜固体润滑轴承是以青铜材料为基体，再埋入固体润滑剂制作而成。其性能与条件、场合与 FB08G 一样。

FB09G is based bronze material and embedded with solid lubricants in its diamond or round shape pockets which are evenly distributed on its inside layers. It has almost the same performance and application condition with FB08G.

最大承载压力	Load capacity	140N/mm <sup>2</sup>
适应温度范围	Temperature limit	-100°C - +250°C
最高滑动速度	Speed limit	1.5M/s
摩擦系数	Friction clef	0.06-0.25
允许最高PV值(干)	PV limit (dry)	2.6N/mm <sup>2</sup> · m/s
允许最高PV值(油)	PV limit (oil)	15N/mm <sup>2</sup> · m/s

## JF-800 双金属轴承 SERIES OF BIMETAL BEARINGS



该产品以优质的低碳钢为基体，表面烧结锡青铜合金，经多次烧结轧制而成，它有很高的疲劳强度和承载能力，高的抗冲击力。产品适用于发动机连杆，变速箱齿轮，工程机械、农业机械等。

The product is made of high quality low-carbon steel, and sintered and rolled copper alloy as its surface. It has high fatigue strength, load capacity and impact strength. The product is applies to com-rod of automobile engines, transmissiom gearbox, engineering and agriculture machinery, etc.

合金层材料	Lead bronze alloy	CuPb10Sn10
最大承载压力	Load capacity	65N/mm <sup>2</sup>
最高使用温度	Temperature max	260°C
合金层硬度	Friction clef	HB(70-100)

## JDB 固体镶嵌轴承 SOLID-LUBRICANT-INLAID BEARING



该产品以特殊配方的高力黄铜为基体，表面按一定角度和密度镶嵌特殊配方的固体润滑剂，经紧密加工而成。产品广泛应用于连铸轧机、矿山机械、船舶、气轮机等。

The product is based on brass of special techniques. The solid lubricant is inlaid by certain angle, density and special formula, and then is processed exactly. The product is widely applied to casting machine, mining machinery, shipping, steam turbine, etc.

基体材质	Base material	CuZn24A16
基体硬度	Base hardness limit	HB230
摩擦系数	Friction clef	< 0.16
最高使用温度	Temp limit	300°C
极限动载荷	Dynamic load limit	100N/mm <sup>2</sup>
1m/min 极限载荷	Load limit under 1m/min	25N/mm <sup>2</sup>
最高滑动速度	Sliding velocity limit	干 0.4m/s 油 5m/s
使用极限 PV 值	PV limit	3.8N/mm <sup>2</sup> · m/s

## JSPD 耐磨板 WEAR-RESISTANT PLATE



该产品以特殊配方的高力黄铜为基体，镶嵌特殊配方的固体润滑剂，精密加工而成。产品广泛应用于瓶坯模等高精度机械。

This product is based on a kind of special technological brass, enchased the special solid lubricant, it is manufactured in exact processes. This product is widely applied to bottled preform molds, etc.

基体材质	Base material	CuZn24A16
基体硬度	Base hardness limit	HB230
摩擦系数	Friction clef	< 0.16
最高使用温度	Temp limit	300°C
极限动载荷	Dynamic load limit	100N/mm <sup>2</sup>
1m/min 极限载荷	Load limit under 1m/min	25N/mm <sup>2</sup>
最高滑动速度	Sliding velocity limit	干 0.4m/s 油 5m/s
使用极限 PV 值	PV limit	3.8N/mm <sup>2</sup> · m/s

## FR 四氟软带轴承 PTFE SOFT STRIPE BEARING



该产品以青铜丝网为基体，单面或双面轧制以聚四氟乙烯 (PTFE) 为主的混合物加工而成。产品广泛应用于纺织机械、关节轴承、轿车门铰链、汽车操纵杆等。

The product is made of bronze mesh and the compound of PTFE is process by rolling on single or double side. The product is widely applied to textile machine, joint bearing, door hinges and joystick of automobile, etc.

最大承载压力	Load capacity	30N/mm <sup>2</sup>
适应温度范围	Temperature limit	-40°C - +260°C
最高滑动速度	Speed limit	2.5M/s
摩擦系数	Friction clef	0.05-0.20
允许最高PV值(干)	PV limit (dry)	1.65N/mm <sup>2</sup> · m/s

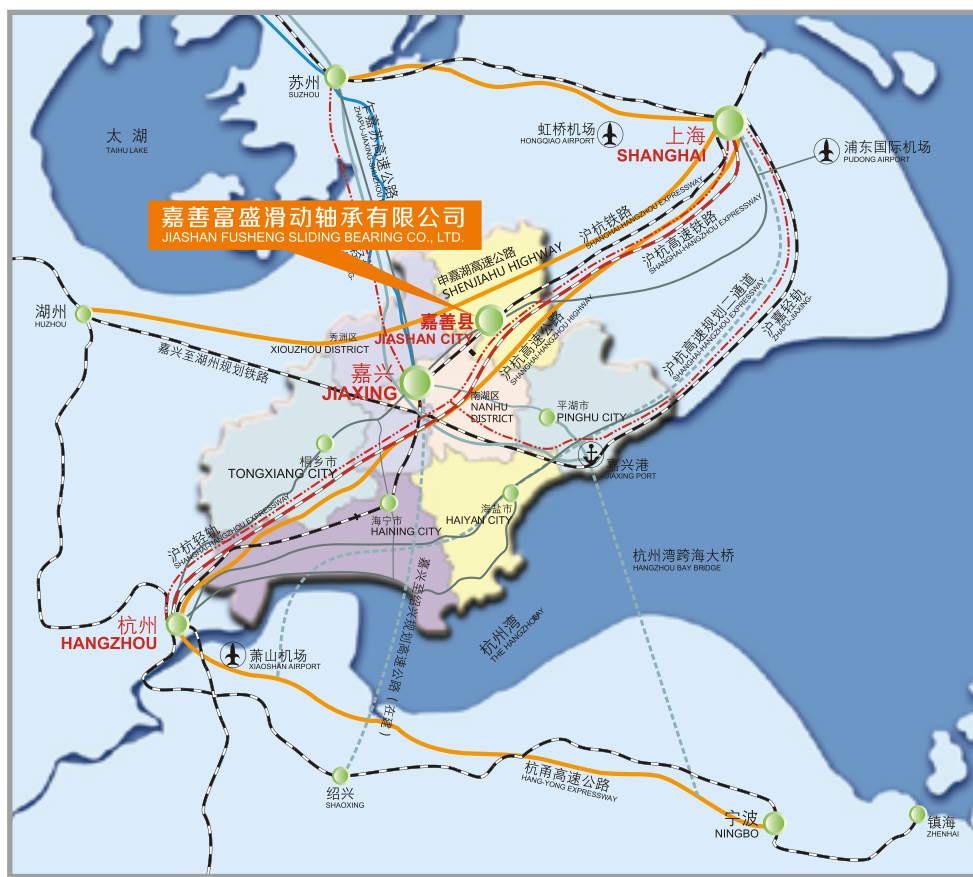

**FSB**  
FUSHENG  
Bearing

## JIASHAN FUSHENG SLIDING BEARING CO.,LTD.

### 嘉善富盛滑动轴承有限公司

地址：浙江省嘉善县干窑镇茆里村 97 号

电话：0573-84517488 84518115 84517758

传真：0573-84517700

邮箱：fsb@fsb-bearing.com

网址：www.fsb-bearing.com

### JIASHAN FUSHENG SLIDING BEARING CO.,LTD.

Add: No.97, Maoli Village, Ganyao Town, Jiashan  
County, Zhejiang Province, China.

Tel: +86-573-84517488 84518115 84517758

Fax: +86-573-84517700

E-mail: fsb@fsb-bearing.com

Http://www.fsb-bearing.com